

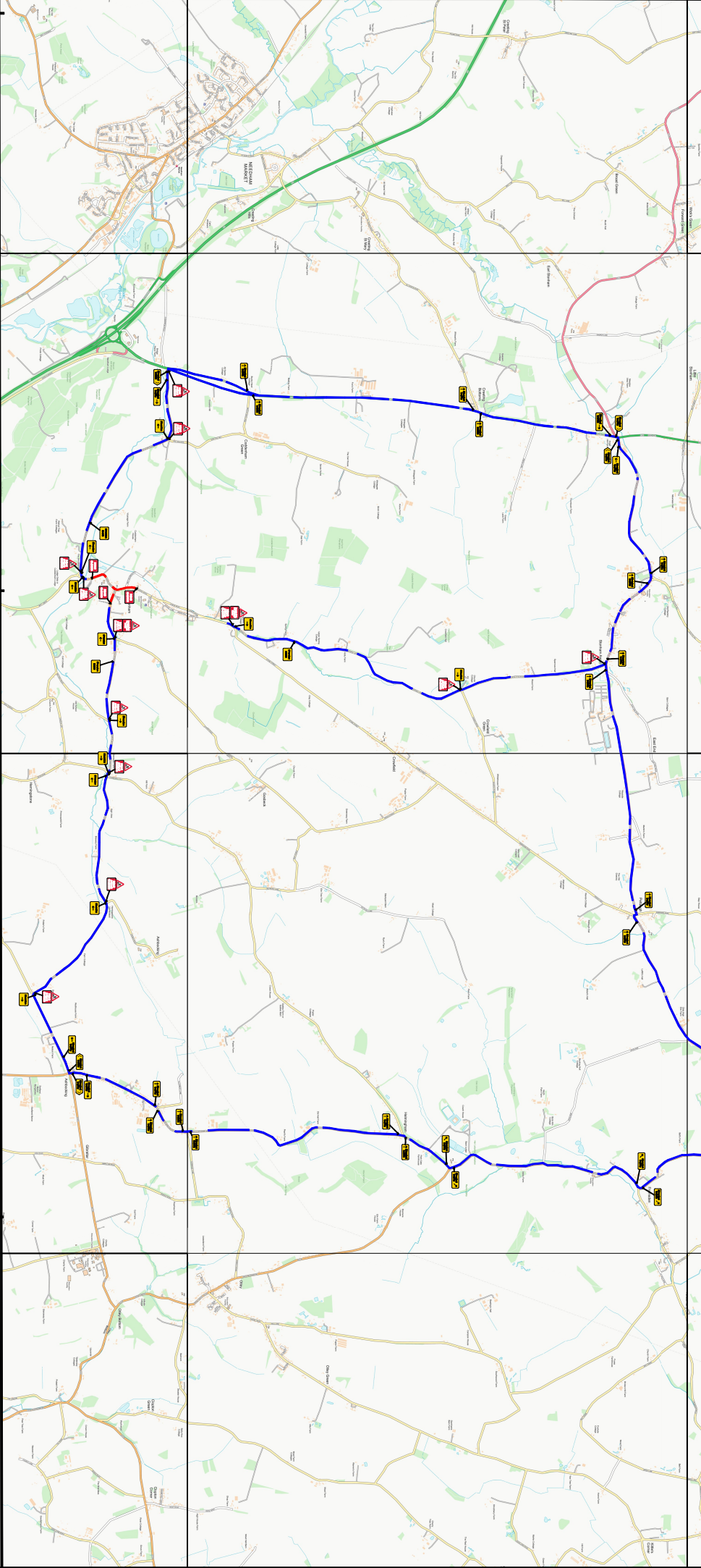

Road Closure

Diversion

Qty: 2 Ref: 139 Schedule 13: Temporary Sign	
Qty: 6 Ref: 2702 Start of temporary diversion route	
Qty: 5 Ref: 2702 Start of temporary diversion route	
Qty: 3 Ref: 2702 End of temporary diversion route	
Qty: 4 Ref: 2703 Direction of temporary diversion route from junction ahead	
Qty: 5 Ref: 2703 Direction of temporary diversion route from junction ahead	
Qty: 16 Ref: 2703 Direction of temporary diversion route from junction ahead	
Qty: 3 Ref: 2703 Direction of temporary diversion route from junction ahead	
Qty: 3 Ref: 2703 Direction of temporary diversion route from junction ahead	
Qty: 3 Ref: 2703 Direction of temporary diversion route from junction ahead	
Qty: 3 Ref: 2704 Direction of temporary diversion route	
Qty: 4 Ref: 2704 Direction of temporary diversion route	
Qty: 12 Ref: 7010 Road works ahead	
Qty: 3 Ref: 7010-PP-13-9 Nature of temporary hazard ahead - Road Closed	
Qty: 12 Ref: 7010-PP-13-9 Nature of temporary hazard ahead - Road Ahead Closed	

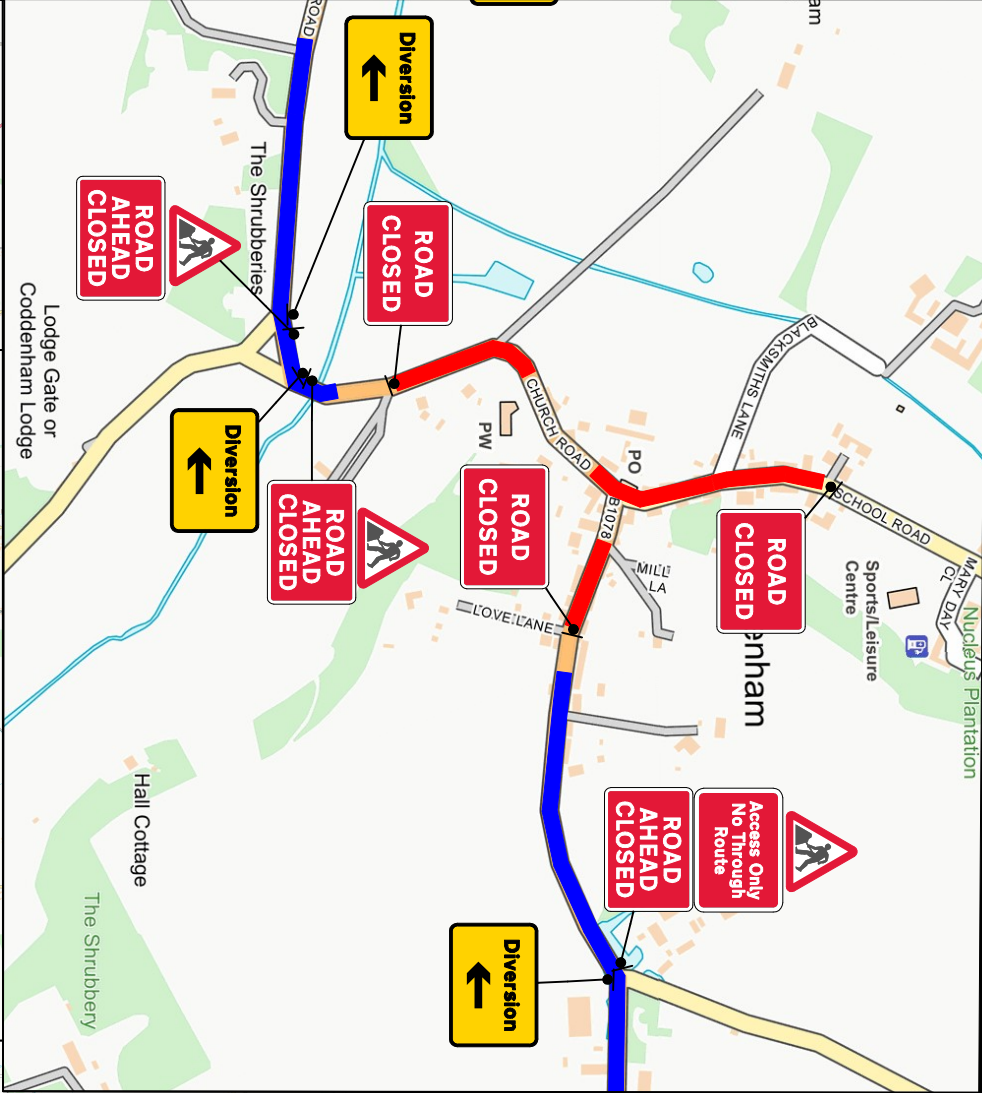

Notes

All dimensions are in metres unless otherwise stated.
TM to comply with Traffic Signs Manual, Chapter 8. All traffic management designs must be checked by a suitably qualified person, as part of the design process.



OCU Opals
017333788878
ocugroup.com/ocu-opals/

Site Address : School Road, Coddtenham, IP6 9PY

Clint Ref : LTM 150
Drawing No 0001
Original drawing size A3 - NTS